

Side view right

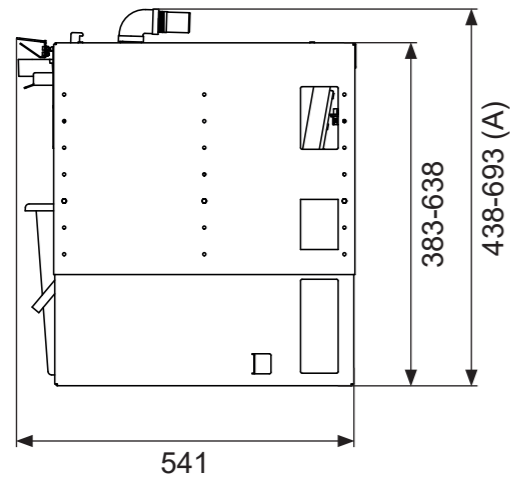

Top view

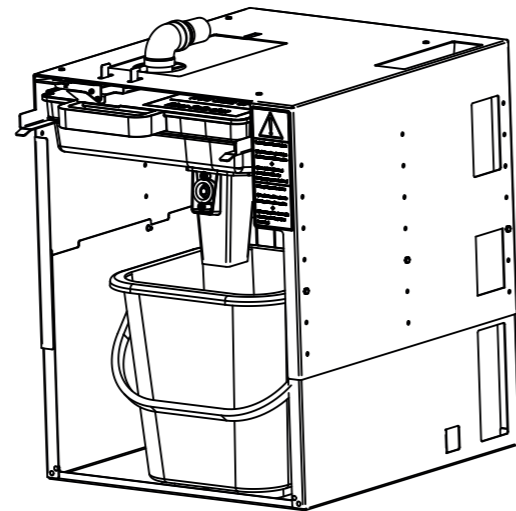
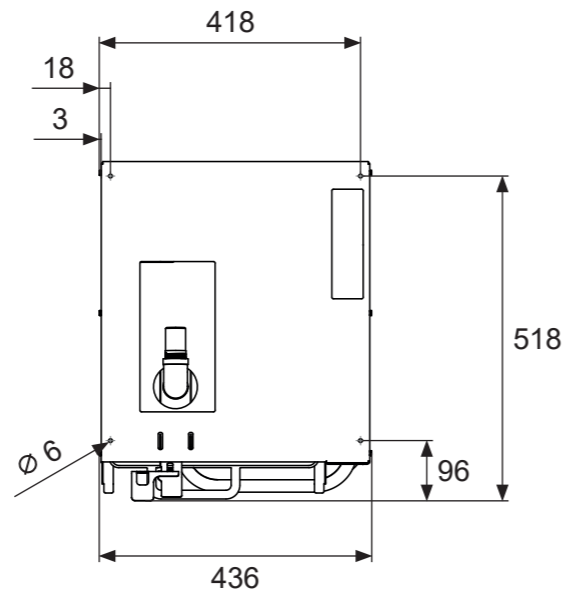

Front view

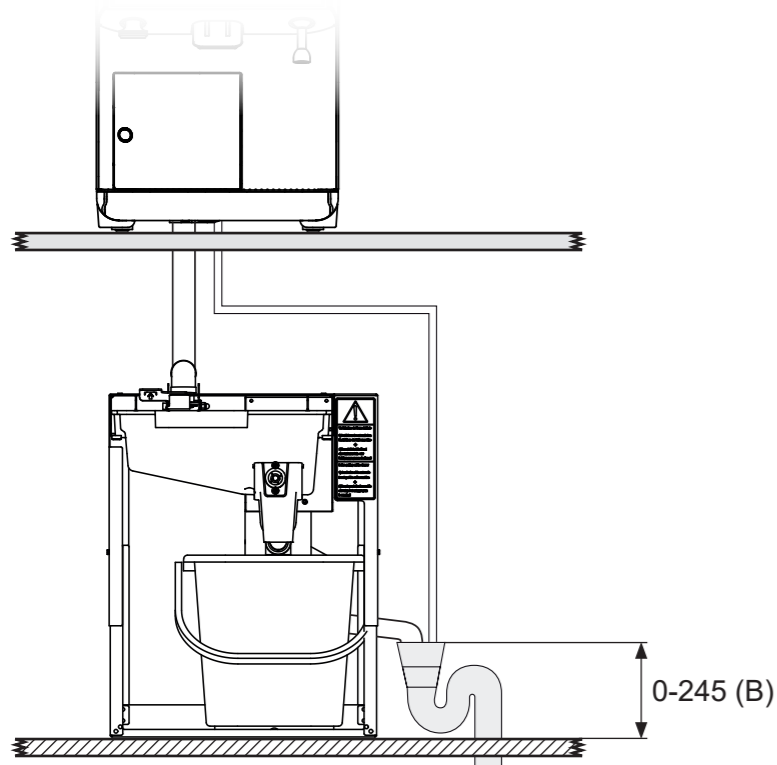

Rear view

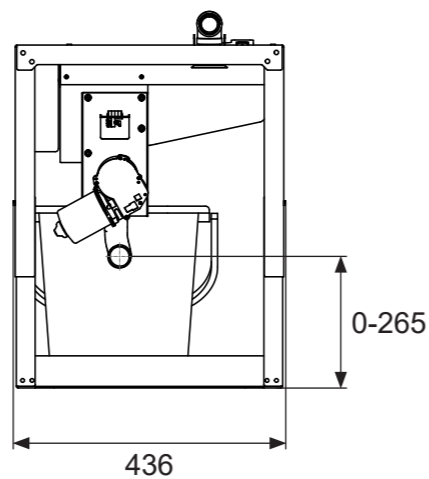

Coffee grounds separator CT-XT

The coffee grounds separator should be screwed to the base/floor during installation. If screwing is not possible, the supplied rubber feet can be used.

To feed-through the connection hoses and connection cables, the aperture for the machine in the table top is used.

The device is supplied with power via the coffee machine.

For the operation of the coffee grounds separator, an easily accessible arrangement must be ensured. It must be possible to remove the separation drawer freely as well as to empty the grounds collection container.

The device is height adjustable in seven steps of 42.5 mm each. Depending on the step, the maximum permissible height of the on-site waste water connection will be lower.

| Step | Height coffee grounds separator (A) | Max. height waste water connection (B) |
|------|-------------------------------------|--|
| 7 | 693 | 245 |
| 6 | 650,5 | 202,5 |
| 5 | 608 | 160 |
| 4 | 565,5 | 117,5 |
| 3 | 523 | 75 |
| 2 | 480,5 | 32,5 |
| 1 | 438 | 0 (floor drain) |

The delivered grounds collection container can be used in the upper three steps.

Dimensions (W x D x H):

436 x 541 x 438-693 mm

Installation weight:

approx. 28 kg

Capacity grounds collection container:

approx. 14 l (approx. 10 kg, approx. 100 l coffee)

Waste water connection:

min. DN 50 - NW 2" – a ventilated odor trap is to be provided

www.planerhandbuch.de

Date: 04/2020
Page: 1/1

Subject to changes.
Property of Melitta®.
Reproduction prohibited.



**Coffee Grounds Separator
CT-XT**
Dimension and datasheet