

User's Manual

For ICEVAN NID series

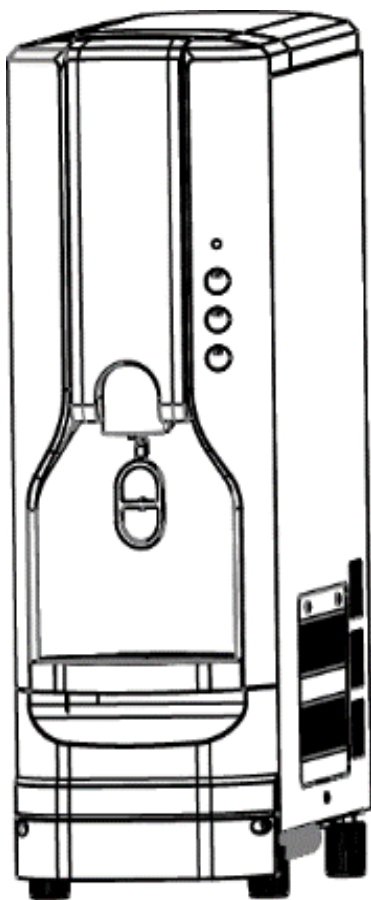

■ ICEVAN Series

- NID-0320B T3
- NID-0520B T3
- NID-0820B T3
- NID-0840B T3
- NID-1220B T3
- NID-1240B T3
- NID-1520B T3
- NID-1540B T3

We really appreciate for your purchasing our ICEVAN.

- ◇ Please read and understand the user's manual carefully to take full advantage of the various and convenient functions of the product.
- ◇ Please check the model you purchased before installing and using the product.
- ◇ Please read this manual carefully and keep it well as it contains important contents for the installer / user when installing the product and using & managing it safely.
- ◇ You can remote control the product through communication.

Contents

1. For your Safety	3~5
2. Components of the machine	6~7
3. Installation and precautions	8~12
- Installation environment	8~10
- Supply and drain of water	11~12
4. How to use	13~14
5. Operation	15~19
- Function of selecting button	15
- Starting the machine	16
- Setup panel (FND)	17
- Setting the function code	18~19
6. Cleaning method	20~21
7. Measures for stopping for a long time	22
8. Trouble shooting	23
9. Error Code	24
10. Parts list to be replaced on a regular basis	25
11. Technical Data	26~27
12. Check List	28
13. Warranty	29~30

1. For Your Safety



Warning

Warning indicates a potential danger which, if not avoided, will result in death or serious injury.



Caution

Caution indicates a hazardous situation which, if not avoided, could result in minor or moderate injury as well as damage to the property.

Warning

▶ Please use exclusive power socket.

- Please use the machine complying with the national and local electric requirements.
- There is a risk of fire when multiple electronic devices are connected.
- There is a possibility of electric shock and fire.

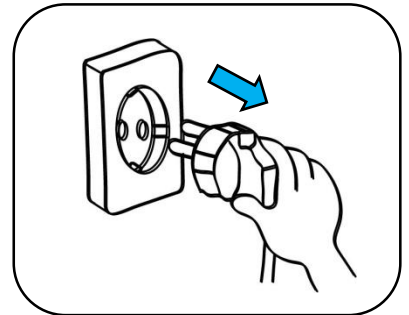

▶ Clean the power plug with dry cloth if it is contaminated.

- There is a possibility of electric shock and fire.

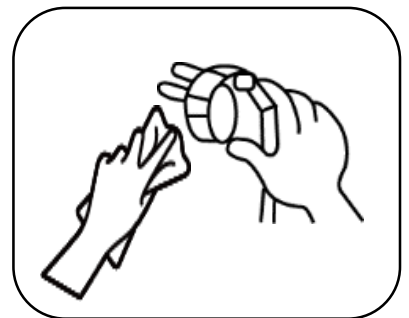

▶ Do not use the power plug if it is loose or damaged.

- There is a possibility of electric shock and fire.
- Please ask the service center for replacing the power plug if it is damaged
- You must get the service from the qualified electrician only.

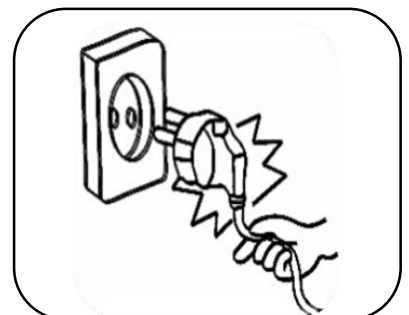

▶ **Do not touch the power plug with wet hand.**

- There is a possibility of electric shock and fire.

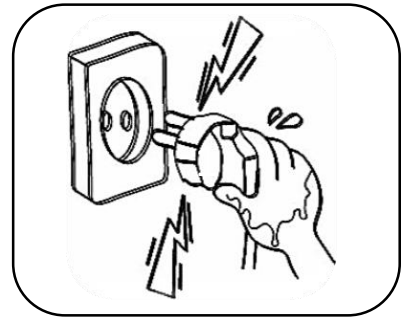

▶ **Always hold the body part of the plug.**

- There is a possibility of fire due to the spark.
- Do not pull the line..

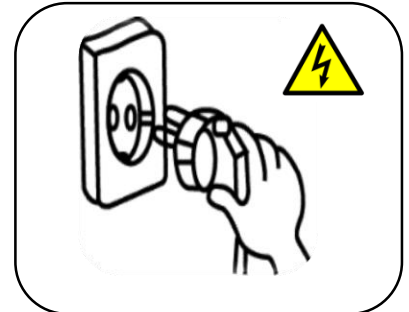

▶ **Please use grounded sockets.**

- There is a possibility of electric shock due to the short circuit.
- This can be the cause of malfunction of product and abnormal operation.

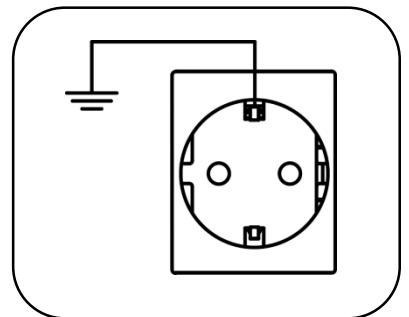

▶ **Do not move or disassemble the ice machine during operation.**

- This can be the cause of the product malfunction.
- There is a possibility of accident by the rotating part.

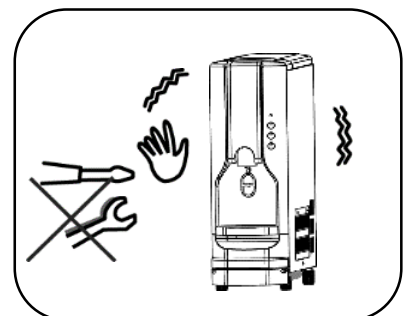

▶ **Stop the machine and pull out the plug if there is smoke, smell or other loud noises different from normal state during operation.**

- Danger of electric shock and fire if used continuously in this state.

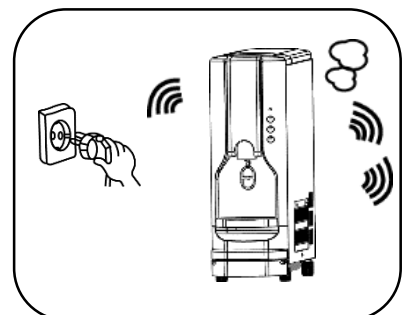



Cautions

▶ Please pass this user's manual together with the ice machine when it is transferred or moved to the others.

- This manual will be required to use the product safely.

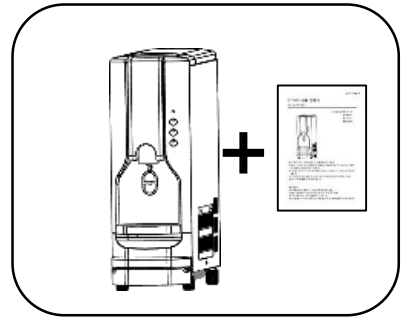

▶ Do not put objects on the top of the ice machine.

- Cooling air inlet and outlet is on the top and bottom of the product respectively.
- It can be the cause of reducing capacity and malfunction of the machine in case air circulation is not good.

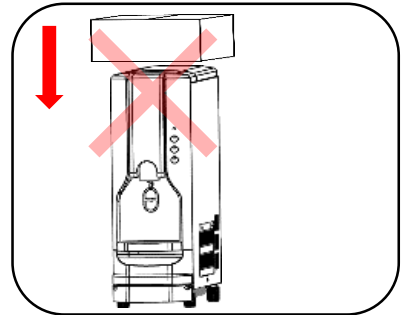

▶ Please clean the parts that corresponds to the cleaning components at the specified intervals.

- This can be the cause of contamination and clogging by the foreign materials.

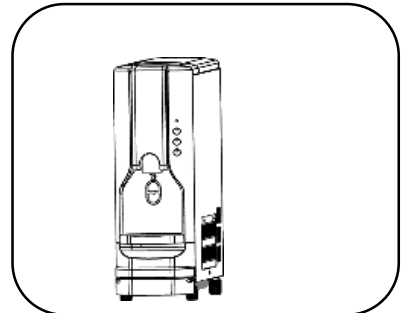

▶ Do not insert sharp objects inside the ice machine.

- This can be the cause of malfunction of the product and damage to the component.

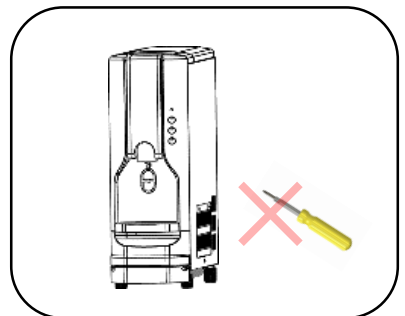

▶ Be careful not to allow the children to play near the machine.

- Please pay special attention if children touch or are playing around the machine.

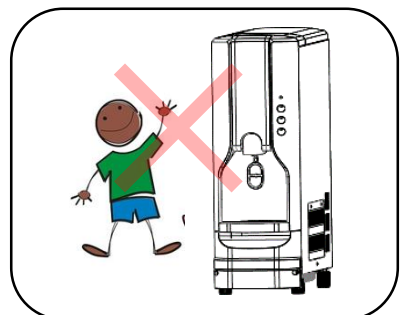

2. Components of Ice machine

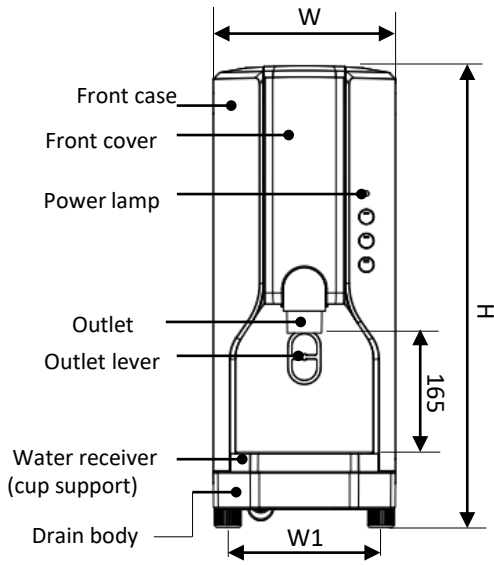

Front view

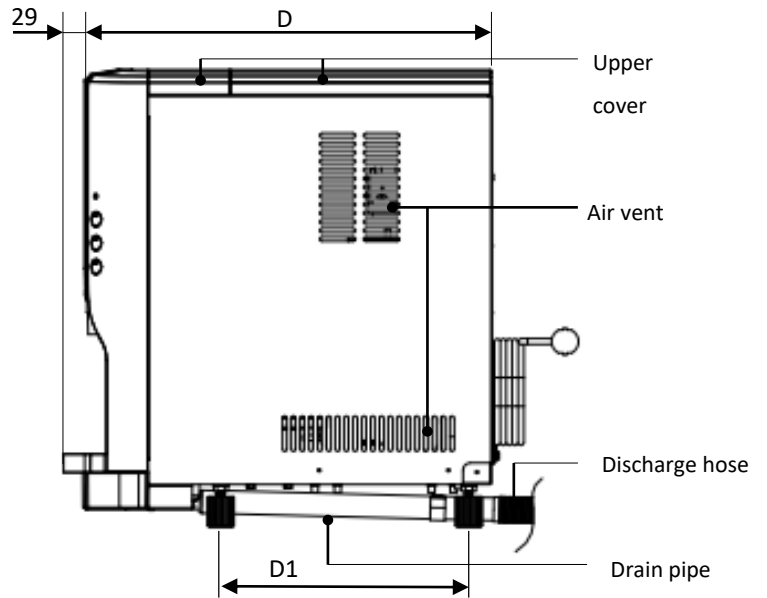

Side view

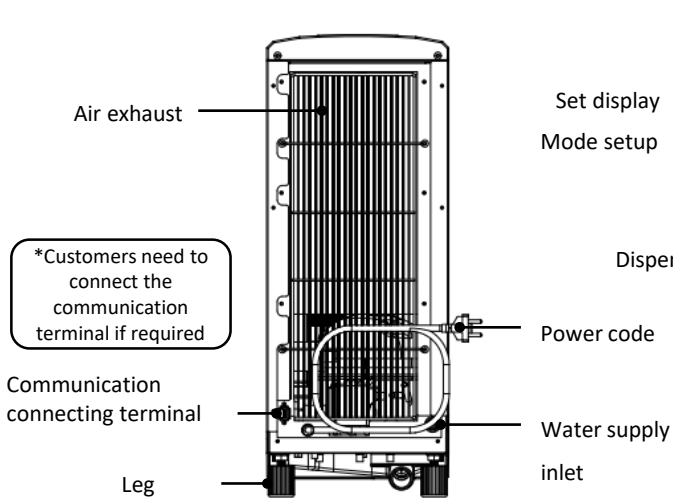

Rear view

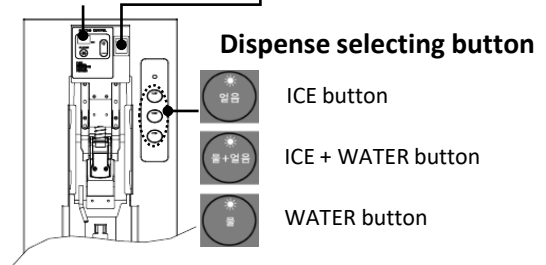
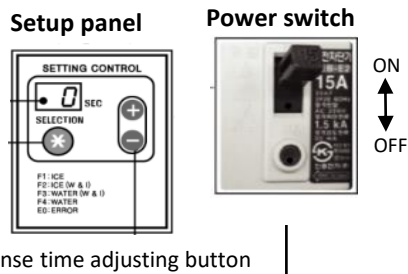

Front cover

※ Components

Parts name	Q'ty
User's manual	1
Water supply hose	1
Drain hose	1
Cup support set	1



User's manual



Water supply Hose



Drain Hose

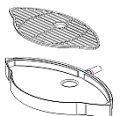

Vessel

2.1 Dimensions

Model Name	Dimension (mm)					Weight (kg)
	W	D	H	W1	D1	
NID-0320B T3	250	513	540	260	315	35Kg
NID – 0520B T3	250	555	635	210	338	40kg
NID – 0820B T3						42kg
NID - 0840B T3	310	593		260	386	47kg
NID - 1220B T3	250	615	745	210	370	53kg
NID - 1520B T3						
NID - 1240B T3	310	625		260	370	58kg
NID - 1540B T3						

3. Installation and precautions

Installation environment

▶ Please keep two people in balance and do not tilt when moving the ice machine.

- This can be the cause of malfunction due to the shaking and noise.
- Be careful not to impact the product.

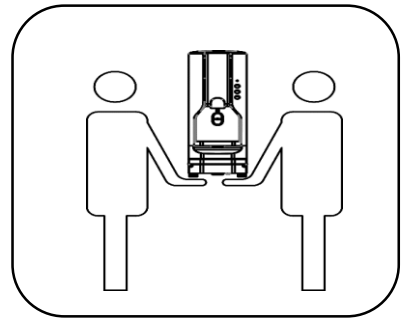

▶ Install the ice machine in a clean indoor place.

- As this is edible ice , Pay attention to hygiene and cleanliness.

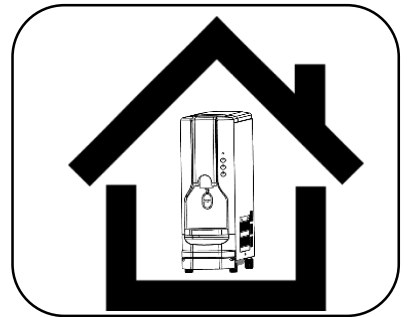

▶ Install the ice machine horizontally on the level and solid surface.

- This can be the cause of malfunction due to the vibration and noise. Fine-tune the level using the adjusting bolt at the bottom.
- Install the product in the manner not to be tipped over or fallen.

(Note: Do not adjust the leg excessively as leg can be separated and the product may fall if the leg is adjusted more than 10mm.)

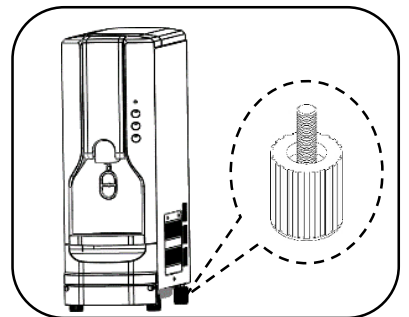

▶ Keep the place not to be contaminated by water, oil, and foreign materials on the floor.

- This can be the cause of injury and breakage of the machine due to the slipping or falling.

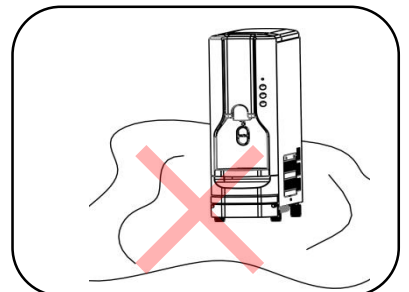

► **Secure the space for the installation of the ice machine.**

- **Narrow space can be the cause of malfunction of the ice machine. Please follow the recommended standard for the checkup and management.**

[Recommended standard:

- Height – over 50cm
- Left & right side – over 10cm
- Rear side – over 10cm]

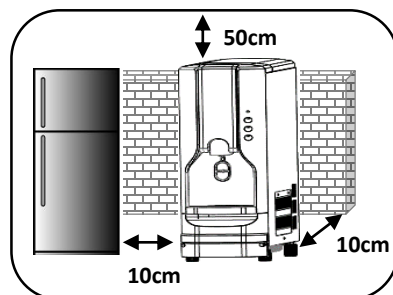

- **Install the ice machine so that the operating status can be checked by opening the front panel.**

► **Install the machine where is ventilated well and keep moisture or water free.**

- **Ice making capacity can be reduced due to the increase of the temperature inside the machine ,if the air is not circulated well.**

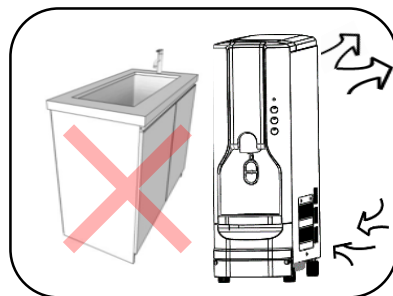

► **Do not install the ice machine beside the heat generating devices such as air conditioner, heater, cooking machine etc.**

- **Increase of surrounding temperature can be the cause of reduction of the ice making capacity.**
- **Please keep the temperature around the ice machine at 10°C~35°C.**
- **It can be the serious malfunction or the cause of safety problems.**

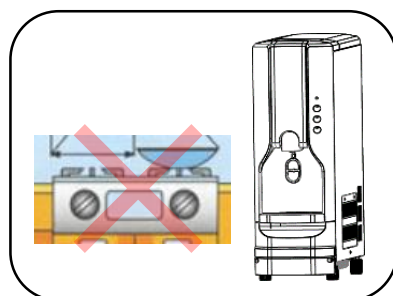

(Note – Our company is not charged in any responsibility for the problems caused by negligence of above notifications.)



- ★ **Parts will be damaged if the ice maker is operated in the place where there is freezing risk!**
- ★ **When operating the ice maker, always keep the ambient temperature above 10°C!**
- ★ **Wait until the ambient temperature is above 10°C and turn off the power, then the error will be cleared.**



Never turn off the power when the ambient temperature drops below zero and errors such as E1, E2, E3 are displayed!

Supply and drain of water

- ▶ Please check the water pressure before connect the water supply fit.

Water pressure : 1~4Kgf/cm² should be maintained

When water pressure is low : use pressurizing pump
(water flow: 1.5~2.0ℓ/min, Pressure: 1~4kgf/cm² pressure type operation pump is recommended)

When water pressure is high : Use decompression valve when the pressure is higher than 4kgf/cm²



※ There is a possibility of water leak in case the water supply pressure is higher than the recommended value due to the Breakage of the components.

- ▶ Please connect the water supply fit as follows.

- Install open & close available hand valve on the water pipe.
- Connect the hand valve and water supplying hole using water supplying hose (1/4").
- Please use the water supplying hose enclosing in the machine as worn out hose could be the cause of water leakage.

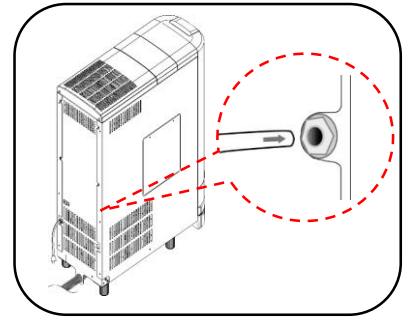

※ 2.5kgf/cm² reduction valve is installed inside the ice machine.



Hand valve

- ▶ Be careful not to exceed 5°C~30°C of supplying water temperature.

- Ice making capacity can be reduced if the water temperature is high and it can be the cause of malfunction if the temperature is low.
- Ice making capacity varies depending on the water and ambient temperature.

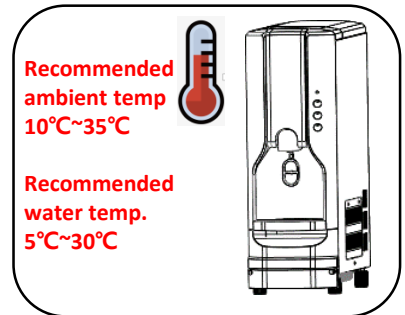

- ▶ Please use drinkable tap water for the supplying water.

- ▶ Please use the filter for calcareous material if lots of calcium compounds is included.

- Too much calcium can cause the reduction of service interval and malfunction.



※ Make sure whether the vessel support is fastened tightly to the body without gap.

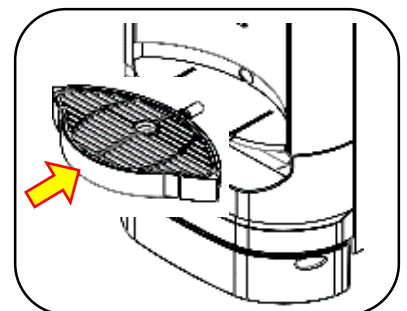

► Install the drain hose so that water can be drained smoothly.

- Be care so that the drain hose should not be installed lower than the drain out-let.



※ Overflowed water may cause a risk of malfunction, electric shock and property damage.

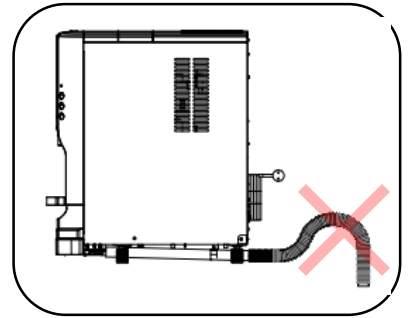

► For the end part of drain hose, install it so that the height can be at least 40cm from the sewer of the ice machine.

- There may be a risk of leakage due to backflow and slow drain speed if the height of the drain hose is too low.
- ※ Odors or mold from the sewer may penetrate into the ice machine if the drain hose is connected to the sewer directly.

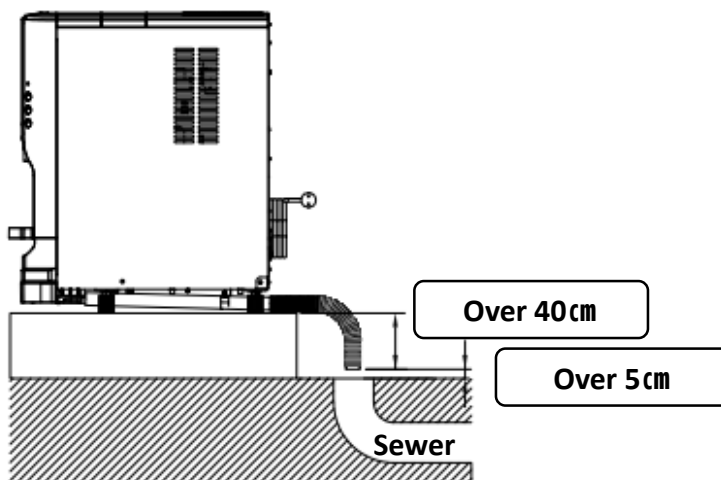

※ Obeying the followings is the must for the sake of quality and safety of the product.

- Since this is a product that requires supply and drainage of water, there is a possibility of water leak in case of inexperienced use during operation.
- For the safe use, please install the machine in the place where to supply and drain water can be done.
- Please install the machine in the place where drain facility is existed to prevent the electric shock and damages to the property due to the water leakage.
 - Take counter measures to prevent the damages due to the water leak before installing the product for the places where there is a possibility of damages due to the leakage.
 - Connect the drain hose to the drainage hole complying with the installation method.

『 Manufacture is not charged in the responsibility for the damages occurred by the insufficient drainage.』

4. How to use



Summary for the correct use of ice machine.

► Front cover

- Release the knob bolt and open the cover.

► Water supplying valve

- Check whether the water supply hose and drain hose are connected properly.
- Open the water supply valve and supply the water to the product.



※ Check leak from the water supplying hose.

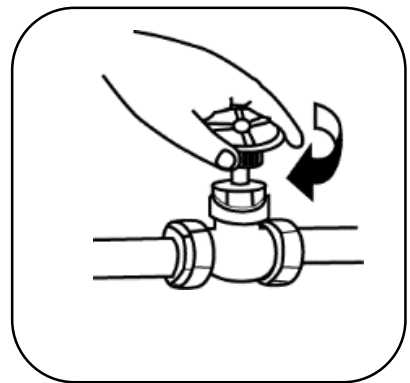

► Power connection

- Check the voltage is suitable for the model.
- Check the circuit breaker is turned off.
- Insert the power plug into the socket.

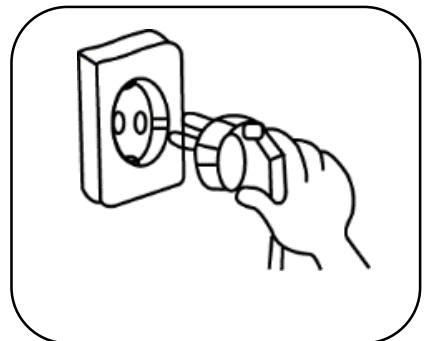

- ◎ Check the power switch on the ice machine is at OFF position when the plug is inserted to the socket.

- ◎ Be careful the power cord is not be damaged by Pressing, stabbing.

- There can be occurred a risk of electric shock and fire.

▶ Power switch operation

- Lift up the power switch to "ON" position.
- Setup panel and power lamp will be turned on when power is supplied



※ **Circuit breaker is to prevent the electric shock due to the short circuit.**

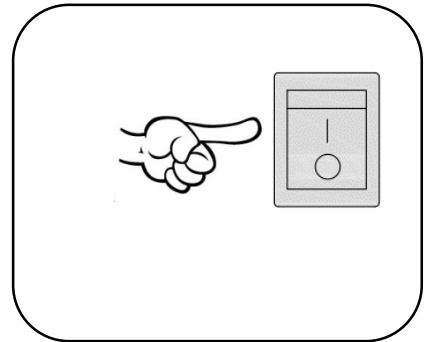

▶ Auto washing

- To supply and drain of water 3 times when power is turned on.
(Washing process takes about 5 minutes)



※ **Check whether there is leakage on the connection part of drain hose.**

[Machine will perform washing process every 10 hours if auto washing operation is set]

▶ Start of ice making

- Ice making process will be started after 3 times of auto wash



※ **Operation sound (gear motor, compressor, fan etc.) will be generated when ice machine is operated. Don't worry, this is normal not malfunction.**

▶ When receiving the ice in the vessel.

- Get the ice first and then add beverage or coffee.

[In case ice is added to the beverage or coffee, contents will be splashed and contaminates the surroundings of the ice machine.]



◎ **Wait at least 5 minutes until you restart the machine after it is stopped.**

If the machine is restarted immediately, it can be the cause of the malfunction.

5. Operation

Summary

The icemaker can be used as a standalone device or in conjunction with coffee machine.
Only use clean and hygienic water (5~30 c)

Function of selecting button

▶ When using “ICE” mode

Ice will be dispensed if dispensing lever is pushed without any operation.
Factory preset mode is “ICE”.

▶ When using “WATER + ICE” mode

Corresponding button will be turned on if you push

“WATER + ICE” button once.

Ice and water will be dispensed if you push dispensing button.

- System will return to the preset mode(ICE) after used once.
within 10 seconds.

▶ “When using “WATER” mode

Push “WATER” button and use the machine.

- System will return to the preset mode (ICE) after used once within 10 seconds.



▶ Set value of initial dispensing time when shipping out the product from the factory

Function key	Function code	Type of mode	Initial set up time
F1	ICE button	Ice	1.5 sec
F2	ICE + WATER button (ice)	Ice	1.5 sec
F3	ICE + WATER button (water)	Water	5.0 sec
F4	WATER button	Water	5.0 sec

※ Please note that the amount of ice per time may be varied slightly by model.

※ Please note that the amount of water discharged at one time may be vary depending on the pressure of the ice making water being supplied.

※ Please change the setting of the dispensing time according to the conditions of use.

◎ Dispensing time for each function can be changed from the Setup panel (FND)
(in 0.1 sec ~ 9.9 sec, every 0.1 sec unit)

(for setting the value, please refer to “page 17”, ice dispense and water dispense time change)

◎ If the vessel is removed from the dispensing lever within the setting time, the dispensing of ice and water will stop, which may be resulted in lack of rated amount.

Starting the Machine

► Starting ice cube production

If the temperature ranges specified in the Technical data are not observed, the ice cube production quantity may be reduced and faults may occur.

Ice cube production starts after three automatic drainage procedures. As soon as the ice cube collecting container inside the device is full, ice cube production is stopped automatically. If ice cubes are dispensed, the ice cube production resumes.

► Dispensing ice cubes and cold water

The factory setting for dispensing ice cubes via the ice cube dispensing button is set to 1.5 seconds. The button for dispensing ice cubes/cold water is set to 1.5 seconds at the factory and the button for dispensing cold water is set to 5 seconds. If these settings need to be changed, contact your service technician.

If the icemaker is used as a standalone device, ice cubes, ice cubes and cold water, or just cold water can be dispensed via the corresponding buttons on the front right of the icemaker.

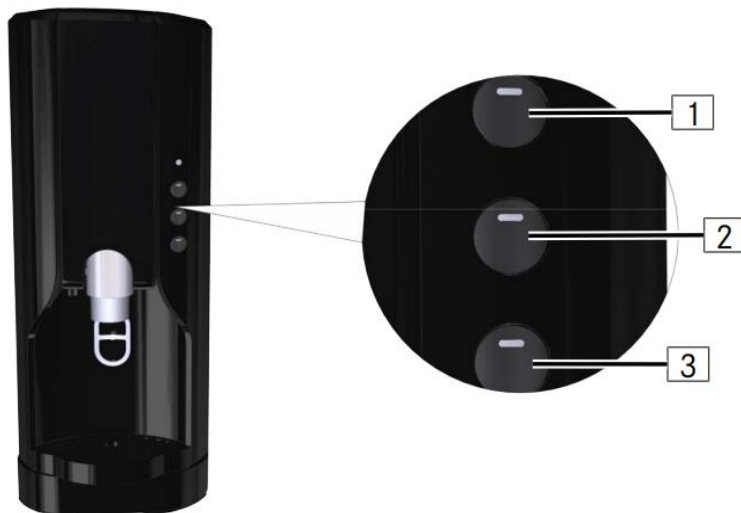

1 Ice cube dispenser button

2 Ice cube dispenser/water button

3 Cold water button

► Dispensing Ice cubes

1. Place a suitable drinking vessel under the ice cube spout.

2. Manually press the ice cube release lever in the direction of the icemaker, or press against the ice cube release lever with the drinking vessel.

► Dispensing Ice cubes and /or cold water

1. Place a suitable drinking vessel under the ice cube spout.

2. Press the required button.

Setup panel (FND)

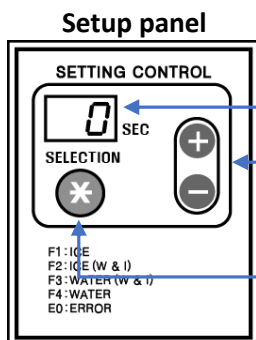







Display window: Displays the function, status value by each function, setup value within the function etc.

Change button (function, setup value): Function and setup value changing button

Select button: Function access, enter the changing setup value, return to the standby screen

► Function setup







Items	Operation
Change of setup screen	If you push "Select  " button for long 3 sec, display window will be changed with beep sound.
Function code move	You can push "Change  " button and move to the desired function
Function code selection	If you push "Select  " button briefly, corresponding setup value will be displayed on the display window.
Setup value change	You can push "Change  " button and change the setup value.
Enter the setup value	You can push "Select  " button shortly and enter the setup value.
Return to the standby screen	If you push "Select  " button for 3 sec, display window will be returned to the standby screen with beep sound.

► Each of the function code







Classification	Function code	Sub-code	Functions
Ice machine dispensing setup function	F0	00 : Ice dispensing	Standard dispensing types
		01 : Ice + water dispensing	
		02 : Water dispensing	
	F1		Ice dispensing time (ice button)
	F2		Ice dispensing time (ice + water button)
F3		Water dispensing time (ice + water button)	
F4		Water dispensing time (water button)	
Ice machine status checkup function	F5	01 : Inside temperature of the product	Displays current temperature of the product inside (°C)
	F6	01 : Condenser temperature	Displays current condenser temperature (°C)
	F7	01 : Evaporator temperature	Displays current evaporator temperature (°C)
	F8		Actual accumulated operation time of Geared Motor (hr)
	F9		Actual accumulated power supplied time
Auto drain function	Fb	00 : Auto drainage OFF	Auto drain function
		01 : Auto drainage ON	

Setting the Function Code





● F0 (Dispenser standard type setup) Ex: [01: Ice dispense + Water dispense]

Operation sequence	Operation button	Operation
1		Push and hold "Select" button for 3 seconds.
2		Push "Change" button and select "F0".
3		Existing setup value will be displayed if you push "Select" button once briefly. (factory default 00)
4		Push "Change" button and change the setup value to "01" (ice dispensing + water dispensing)
5		You can push "Select" button once briefly and enter the setup value.
6		If you push and hold "Select" button for 3 sec, display window will be returned to the standby screen with beep sound.

● F1~F4 (Ice dispense and water dispense time change) Ex: [F1: Ice dispense time setup: Ice dispense for 5 sec]





Operation sequence	Operation button	Operation
1		Push and hold "Select" button for 3 seconds.
2		Push "Change" button and select "F1".
3		Existing setup value will be displayed if you push "Select" button once briefly (factory default is 1.5)
4		Push "Change" button and change the setup value to "5.0" (dispensing time)
5		You can push "Select" button once briefly and enter the setup value.
6		If you push and hold "Select" button for 3 sec, display window will be returned to the standby screen with beep sound.

● F5~F7 (check the dispenser temperature) Ex: [F5: check the product inside temperature]

Operation sequence	Operation button	Operation
1		Push and hold "Select" button for 3 seconds.
2		Push "Change" button and select "F5".
3		If you push "Select" button once briefly, # 01 will be displayed.
4		If you push "Select" button once briefly, "temperature" will be displayed.
5		If you push and hold "Select" button for 3 sec, display window will be returned to the standby screen with beep sound.

● F8~F9 (Function to check the time of use of the ice machine)

Ex : [F8: Actual accumulated operation time of Geared Motor]

Operation sequence	Operation button	Operation
1		Push and hold "Select" button for 3 seconds.
2		Push "Change" button and select "F8".
3		If you push "Select" button once briefly, "time" will be displayed.
4		If you push and hold "Select" button for 3 sec, display window will be returned to the standby screen with beep sound.







● Display window usage time conversion table [use F8, F9]

Mark	Time (Hr)	Mark	Time (Hr)	Mark	Time (Hr)	Mark	Time (Hr)
0 0	-	0 0.	10,000	0.0	20,000	0.0.	30,000
0 1	100	0 1.	10,100	0.1	20,100	0.1.	30,100
1 0	1000	1 0.	11,000	1.0	21,000	1.0.	31,000
9 9	9900	9 9.	19,900	9.9	29,900	9.9.	39,900

* It is possible to manage the life time of major parts and also, you can replace them regularly by checking the accumulated operating time of the F8 geared motor.

*Regular replacement is recommended to maintain the quality of the ice. [refer to [page 24](#) for the parts list that is for the parts to be replaced on a regular basis]

● Fb Auto drain ON/OFF set up function Ex: [00: Auto drain OFF setup]

Operation sequence	Operation button	Operation
1		Push and hold "Select" button for 3 seconds.
2		Push "Change" button and select "Fb".
3		Existing setup value will be displayed if you push "Select" button once briefly (factory default is 01)
4		Push "Change" button and change the setup value to "00" (auto dispense OFF)
5		You can push "Select" button once briefly and enter the setup value.
6		If you push and hold "Select" button for 3 sec, display window will be returned to the standby screen with beep sound.

* Automatic drainage operates once every 10 hours, and water in the machine (reserve tank, hose) will be automatically drained which enables to use hygienically

(prevents sediments to be accumulated in the water tank)

* Automatic draining function can be set to "Off" in the places where draining is not easy (⊗ initial 3 times draining operation will be executed even though auto drain function is turned off).

6. Cleaning method



※ Following is the must to be obeyed.

Do not use abrasive powder, powder soap, oil, loofah, acid, thinner, benzene, or alkaline detergent as they may damage the paint or plastic.

- Please use the cleaning agent and disinfectant after checking the precautions on the label of each product container.
- It may cause health problems or rust If the cleaning agent and disinfectant remain on the surface of the product after cleaning which must be removed.
- Please clean the outlet every day (it can be the cause of hygiene problems due to the build-up bacteria, germs, limescale and mildew.)
Please use a clean dishcloth when cleaning the machine.
- Be careful not to let water enter the product when cleaning the machine (It can be the cause electric shock or malfunction)

Cleaning agents and disinfectants must keep away from children, beverage.

► Preparation

Container	Container to receive the ice
Detergent	Neutral detergent for kitchen (dilute according to concentration – water 1,000cc : neutral detergent 2.0ml)
Disinfectant	Rubbing alcohol (dilute according to concentration – concentration 50~80%)
	Sodium hypochlorite aqueous solution (Lax). (dilute according to concentration – water 1,000cc : neutral detergent 3.3ml)
Brush	Brush with soft bristles
Water	Warm water lower than 40°C of temperature
Dishcloth	For the removal of moisture

► **Cleaning method**

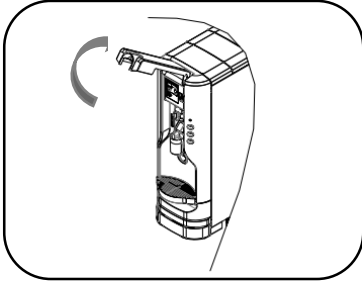

1) Loosen the bolt and open the front cover.

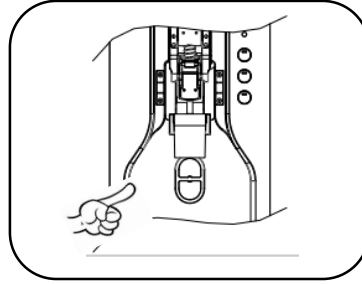

2) Push the lever and dispense the ice.

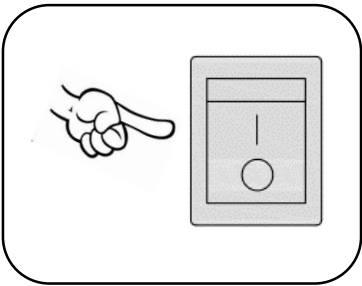

3) Turn off the power switch.

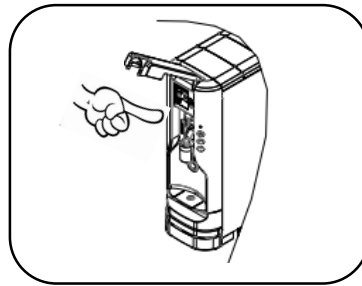

4) Clean the outlet area.

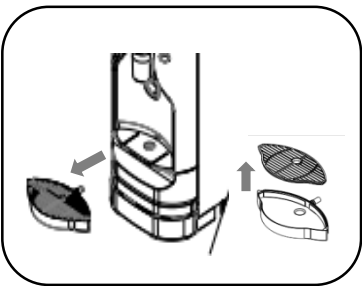

5) Remove the vessel support and clean.

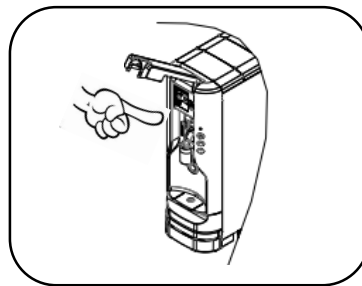

6) Wipe off the cleaned area with clean dishcloth.

Clean the outlet and front area with dishcloth

► **Cleaning cycle**

Inspection interval	Position	Content
Daily	Ice dispensing	Sterilize with a disinfectant (alcohol), clean with a soft brush, and then wipe off the disinfectant with a cloth.
Daily	Cup support	Clean with a soft brush and water.
Daily	Around cup support	Keep the area around the cup support clean.
Weekly	Appearance of the product	Remove the stain with a dry cloth.

7. Measures when stopped for a long time

► Obey the instruction below when not dispensing ice without turning off the power

1. When without turning of the power

- 1) Dispense and waste at least 5 cups of ice on a regular basis (once a day)
- 2) Do not store the ice in the storage for longer than 1 week left. it may cause damage to the machine due to the overload by stick together.

2. Follow the instruction when you turn off the power and leaving it for a extended period of time.

- 1) Close the water supply valve of the ice maker.
- 2) Push the dispense lever and dispense all of the ice in the storage tank.
- 3) Automatic drain function will be activated and drain all the water inside the ice machine if you turn off and on the power switch (ELB) (hand valve needs to keep the closed state when manipulating the power switch).
- 4) Turn off the power switch and disconnect the plug from the docket when draining process is completed.

© When the ice is stored for a long time, pay attention to the surrounding environment.

- Free from moisture, wind, direct sunlight, dust and moisture.

8. Trouble Shooting



※ Please check the followings first in case any problem occurs during operation of the ice machine. If the symptom is not resolved in spite of following counter actions, please contact with the purchased place for the help.

Please provide following information when requesting the service.

- (① Symptoms ② Model ③ Manufacturing number ④ Name, address, contact No.
⑤ Date that you want to get service)

Symptoms	Check point	Counter actions
Power does not turn on.	<ol style="list-style-type: none"> 1) Isn't the power unplugged? 2) Isn't the power switch turned off? 	<ol style="list-style-type: none"> 1) Insert the power plug into the socket. 2) Turn the power switch on.
Power lamp is turned off and 3 selection button lamp is blinking.	<ol style="list-style-type: none"> 1) Open the front cover and check the display window. 	<ol style="list-style-type: none"> 1) Please refer to the notification function table (refer to error indication and counter action on page 25)
No ice is dispensing.	<ol style="list-style-type: none"> 1) Isn't the ice being manufactured? 2) Isn't the outlet blocked? 3) Isn't the ice stuck together because the ice not been used for a long time? 4) Isn't the area around the ice machine blocked? 	<ol style="list-style-type: none"> 1) Use the machine after certain amount of ice is made. 2) Remove the ice on the outlet. 3) Turn off the power and use again after the stuck ice has completely melted. 4) Let the air circulates smoothly.
No water is dispensing.	<ol style="list-style-type: none"> 1) Isn't the valve on the water supply pipe closed? 2) Isn't there a outage of water? 3) Isn't the water filter installed outside of the product clogged? 	<ol style="list-style-type: none"> 1) Open the water supply valve. 2) Use after water is supplied. 3) Replace the water purifying filter.
Water flows on the bottom of the machine.	<ol style="list-style-type: none"> 1) Isn't the water receiver missing? 2) Isn't the drain hose clogged? 3) Isn't there any place where the middle of the drain hose bent or curved up and down? 4) Isn't the drain hose assembly location changed? 	<ol style="list-style-type: none"> 1) Insert the water receiver correctly. 2) Clean the blocked part of the drain hose. 3) Straighten the bent or curved part of the drain hose. 4) Correct the drain hose assembly direction.
When there is abnormal noise.	<ol style="list-style-type: none"> 1) Did you turn on the ice machine immediately after it is turned off? 	<ol style="list-style-type: none"> 1) Please wait approx. 5 minutes and then start operation.

※ Contact with the purchased place if the problem is not solved after the counter action.

9. Error Code

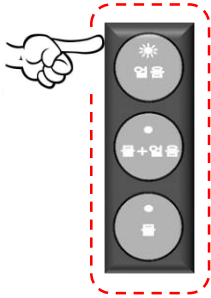

※ Three front selection button lamps blink at the same time, and the ERROR indication code appears on the display window as follows.

Error code	Description of error	Counter actions
E1	Poor water supply	<ol style="list-style-type: none"> 1) Check the connection of the water supply pipe and also check whether there is outage of water supply. 2) Check if the water supply is insufficient because the water pressure in the water supply pipe is low. 3) Check if there is any problem with the water supply system and filter is clogged. 4) If the symptom persist, contact with the purchased place. <p>※ Corresponding situation will be released when the power switch is turned off and on after counter action is taken.</p>
E2	Poor drainage	<ol style="list-style-type: none"> 1) Please turn the power switch off and on. 2) If the symptom persist, please contact with the purchased place.
E3	When the inside temperature is lower than 5°C	<ol style="list-style-type: none"> 1) When the room temperature is 5°C or higher, system will return to the normal state
E4	When the machine inside temperature is higher than 50°C.	<ol style="list-style-type: none"> 1) When the internal temperature of the product is lower than 50°C, system will return to the normal state.
E5	Over heat of the condenser	<ol style="list-style-type: none"> 1) Check if hot air is introduced into the product due to the heat source around the product. 2) Check if the air inlet or outlet is blocked with product or object. 3) Turn off the power and restart after 30 minutes passed. 4) If abnormal symptoms persist, contact with the purchased place.
E6	Super cooling of evaporator exit	<ol style="list-style-type: none"> 1) Turn off the power and restart after 30 minutes passed. 2) If abnormal symptoms persist, contact with the purchased place.
E7	Abnormal geared motor (ice making motor)	<ol style="list-style-type: none"> 1) Turn off the power and restart after 30 minutes passed. 2) If abnormal symptoms persist, contact with the purchased place.
E8	Poor ice making function	<ol style="list-style-type: none"> 1) Turn off the power and restart after 30 minutes passed. 2) If abnormal symptoms persist, contact with the purchased place.
E9	Periodic inspection alarm	<ol style="list-style-type: none"> 1) Request periodic inspection (periodic inspection)
EC	Abnormal communication	<ol style="list-style-type: none"> 1) Request inspection to the purchase place (periodic inspection)
Ev	Voltage mismatch	Check the power supply voltage (mismatch when +15% -15% of rated voltage)

10. Parts list to be replaced on a regular basis

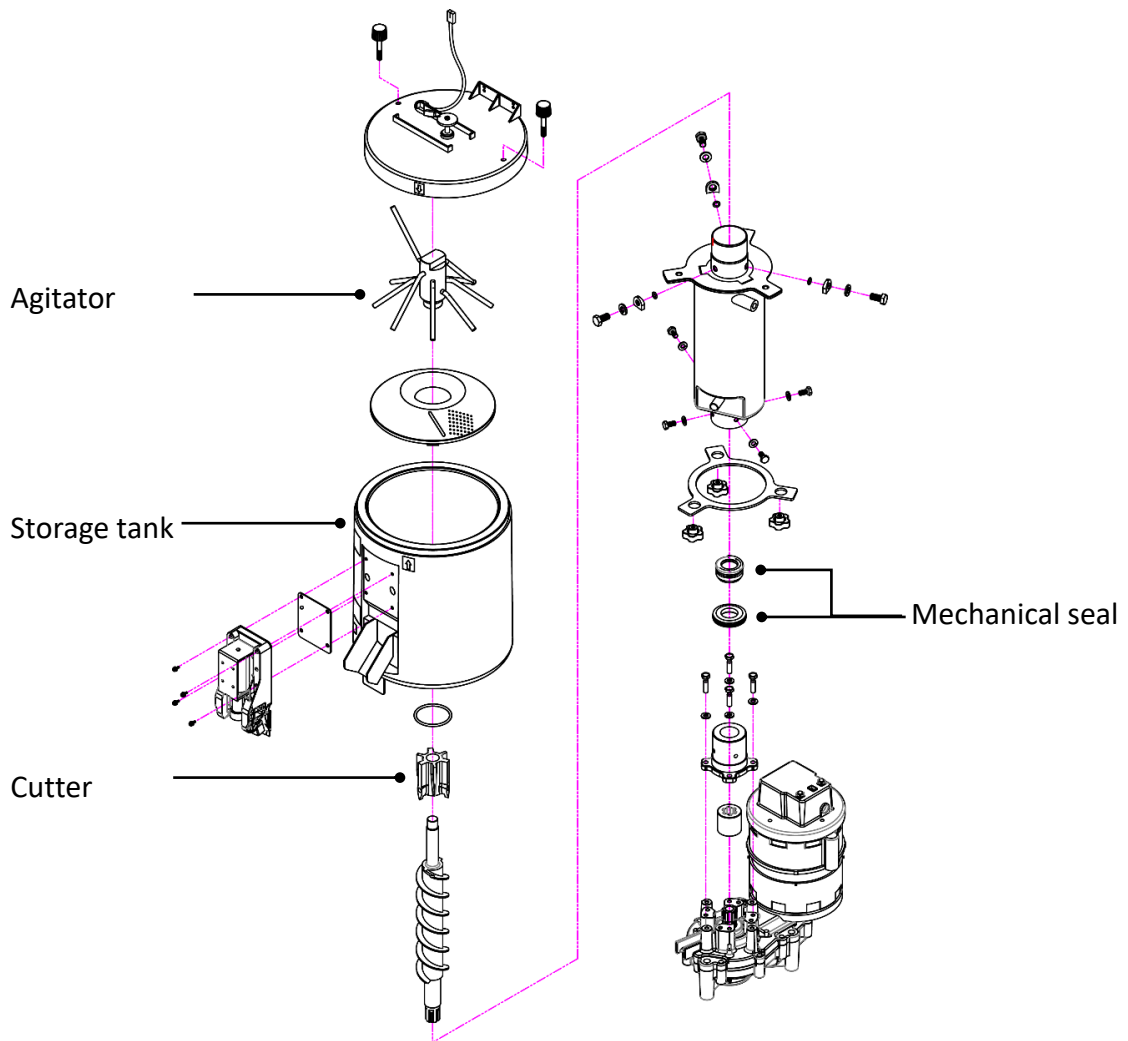

※ Be sure to replace the cutter and mechanical seal according to the replacement cycle (request to the purchased place)

- Replacement cycle varies depends on the water quality, installation condition and operation rate.
- We recommend beforehand checkup and maintenance.



You can check the replacement time from the display window "F8" item (actual accumulated operation time of Geared Motor).

Parts list	Replacement cycle
Cutter	3 years / 5,000h
Mechanical seal	3 years / 5,000h
Ice storage tank	5 years
Agitator	5 years

11. Technical Data

Model Name		NID-0320B T3	NID-0520B T3	NID-0820B T3	NID-0840B T3
Manufacturer		Korea Nakajo Co., Ltd			
Product Name		Ice Dispenser Ice Machine			
Electrical appliances safety certification	Electrical safety Certification No.				
	Electromagnetic No.				
Appearance	Dimension (mm)	(W) * (D) * (H) 250 * 513 * 540	(W) * (D) * (H) 250 * 555 * 635	(W) * (D) * (H) 250 * 555 * 635	(W) * (D) * (H) 310 * 593 * 635
	Weight (kg)	Approx. 35 kg	Approx. 40 kg	Approx. 42 kg	Approx. 47 kg
Power	Power	AC 220V, 50/60 Hz			
	Current	2A	2A	2.5A	
	Power consumption	350W	350W	500W	
Refrigerant	Type	R-134a	R-290	R-134a	
	Refrigerant amount	80g	85g	240g	
Ice amount	Ambient Temp. : 20°C Supply water Temp. : 15°C	Approx. 30 kg/day	Approx. 50 kg/day	Approx. 80 kg/day	
	Ambient Temp. : 30°C Supply water Temp. : 25°C	Approx. 23 kg/day	Approx. 40 kg/day	Approx. 65 kg/day	
Ice storage capacity		Approx. 1.9 kg	Approx. 1.9 kg	Approx. 1.9 kg	Approx. 4.0 kg
Commodity types (3 kinds)		Ice, Ice + Water, Water			
Water supplying method		Connect tap water directly			
Water pressure		98kPa~392kPa is recommended (1.0~4.0kgf/cm ² is recommended) (Use pressure reduction valve when water pressure is higher than 392kPa) ※ Water pressure 392KPa = 4.0kgf/cm ²			

11.1 Technical Data

Model Name		NID-1220B T3	NID-1240B T3	NID-1520B T3	NID-1540B T3
Manufacturer		Korea Nakajo Co., Ltd			
Product Name		Ice Dispenser Ice Machine			
Electrical appliances safety certification	Electrical safety Certification No.			JH07789-20001	
	Electromagnetic No.			R-R-K0N-NID-1520BT3WR	
Appearance	Dimension (mm)	(W) * (D) * (H) 250*615*745	(W) * (D) * (H) 300*625*745	(W) * (D) * (H) 250*615*745	(W) * (D) * (H) 310*625*745
	중량 (kg)	53 kg	58 kg	53 kg	58 kg
Power	Power	AC 220V, 60 Hz			
	Current	3.0 A		4.5 A	
	Power consumption	600W		950W	
Refrigerant	Type	R-134a		R-404A	
	Refrigerant amount	260 g		270g	
Ice amount	Ambient Temp. : 20°C Supply water Temp. : 15°C	Approx. 120 kg/day		Approx. 150 kg/day	
	Ambient Temp. : 30°C Supply water Temp. : 25°C	Approx. 110 kg/day		Approx. 135 kg/day	
Ice storage capacity		Approx. 1.9 kg	Approx. 4.0 kg	Approx. 1.9 kg	Approx. 4.0 kg
Commodity types (3 kinds)		Ice, Ice + Water, Water			
Water supplying method		Connect tap water directly			
Water pressure		98kPa~392kPa is recommended (1.0~4.0kgf/cm ² is recommended) (Use pressure reduction valve when water pressure is higher than 392kPa) ※ Water pressure 392KPa = 4.0kgf/cm ²			

12. Check List

※ Once the installation is completed, check the items listed in the check list to see if there is any problem and put the check mark in the box [V] and sign on the check list and keep it.

Check point	Check mark	Remarks
1. Is the ice machine installed indoors in a clean place?	<input type="checkbox"/>	
2. Is it installed in a place free from moisture and well ventilated?	<input type="checkbox"/>	
3. Is there any air conditioner, heat generator, or cooking appliance that generate heat around the machine?	<input type="checkbox"/>	
4. Is the ice machine installed on the flat, firm and level surface?	<input type="checkbox"/>	
5. Did the surrounding space that is recommended in the manual secured?	<input type="checkbox"/>	
6. Did you follow the installation condition so that drainage can be done smoothly.	<input type="checkbox"/>	
7. Did you follow the safety precautions when installing the machine?	<input type="checkbox"/>	
8. Did you connect the grounding to be suitable for the standard?	<input type="checkbox"/>	
9. Did you connect in the manner not to be leaked on the water supply and drainage part?	<input type="checkbox"/>	
10. Did you connect the cup support correctly?	<input type="checkbox"/>	
11. Is the operation suitable after the installation?	<input type="checkbox"/>	
12. Did you check the dispensing of ice 10 minutes after turning on the power?	<input type="checkbox"/>	
13. Did you check the time to be required for the initial ice full?	<input type="checkbox"/>	
14. Did you fully explain the operation method to the customer?	<input type="checkbox"/>	

※ Following is the important information for the follow up service which must be recorded.

■ Installation company _____
 ■ Person in charge of installation : _____
 ■ Company contact # _____

■ Confirmation of the customer _____

13. Warranty

※ Conditions of free of charge

1. For the malfunctions in performance or function that occurs under the normal use within the warranty period

※ Paid Maintenance

Service cost will be charged for the following cases even within the warranty period.

1. When malfunction or damage occurred due to user's carelessness (moving, dropping, impact, excessive operation, etc.) after installation
2. When malfunction occurs due to the disassembly of the product by the person other than the designated engineer of the purchase place.
3. When malfunction occurs due to the improper installation or use that is not suitable for the intended use
4. When failure occurs due to the natural disasters such as fire, earthquake, flood, lightning, or abnormal power etc.
5. When failure occurs due to freezing or clogging of supply and drain pipe
6. When malfunction occurs because the machine is not installed according to the installation standards of the user's manual
7. When failure occurs due to non-compliance with the safety standards of the user's manual
8. When the ice making performance is affected by the problems of the surrounding environment.
9. When the malfunction occurs due to a faulty by peripheral device(like as related to electricity and water supply)
10. In case of reinstallation due to the move of the product.
11. In case of is reinstallation due to the incorrect initial installation because it was conducted not by the purchased place.

Letter of Warranty

Product Name	Ice Machine	Warranty Period
Model Name		1 Year
Manufacturing No.		

- ▶ This product is released after thorough quality control and strict inspection.
- ▶ This product will be repaired free of charge if malfunction occurs within one year from the date of purchase.
- ▶ In the following cases, service will be charged even within the warranty period.
 1. When malfunction or damage occurred due to user's carelessness (moving, dropping, impact, excessive operation, etc.) after installation.
 2. When malfunction occurs due to the disassembly of the product by the person other than the designated engineer of the purchase place.
 3. When malfunction occurs due to the improper installation or use that is not suitable for the intended use
 4. When failure occurs due to the natural disasters such as fire, earthquake, flood, lightning, or abnormal power etc.
- ▶ We are not responsible for safety accidents caused by customer's negligence.

Date of sale	. . .	
Customer	Name:	Phone No.:
	Address:	
Sales Office	Name:	Phone No.:
	Address:	

■ Manufacturer : Korea Nakajo Co., Ltd
 WWW.icevan.co.kr
 65, Yongdu-ro, Daegot-myeon, Gimpo-si,
 Gyeonggi-do, Republic of Korea
(031) 998-0671

■ Salesperson : _____
 Address: _____
 Contact No. : _____
 Installed by: _____



■ Manufacturer : Korea Nakajo Co., Ltd

65 Yongdu-ro, Daegot-myeon,
Gimpo-si, Gyeonggi-do ☎ 10038

TEL : +82 - 31 - 998 - 0671

FAX : +82 - 31 - 998 - 0644

www.icevan.co.kr